

Revisions:

No.	Date	Description

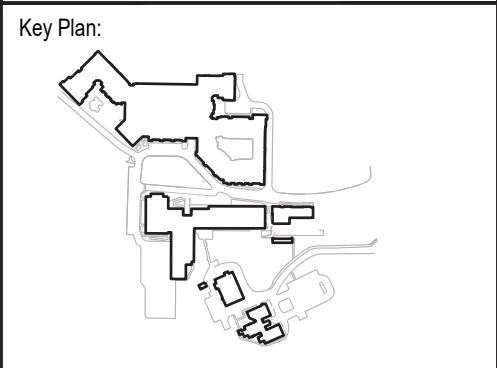
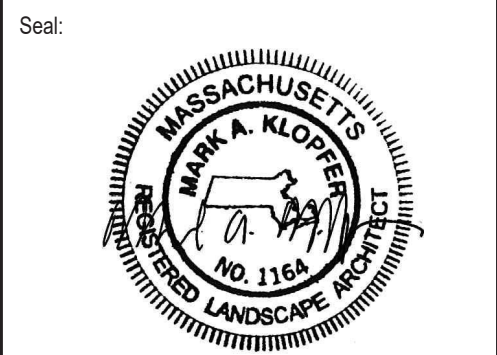

Issued For:
**PERMITTING
 (NOT FOR CONSTRUCTION)**

Scale: AS NOTED
 Date: JUNE 9, 2026
 Drawn By: HH/LR/SA/DG
 Reviewed By: JNE/B
 Approved By: MK
 KMDG Project No.: 2225.03

Drawing Title:
**TRAILHEAD
 IMPROVEMENTS**

Sheet Number:
L1.1

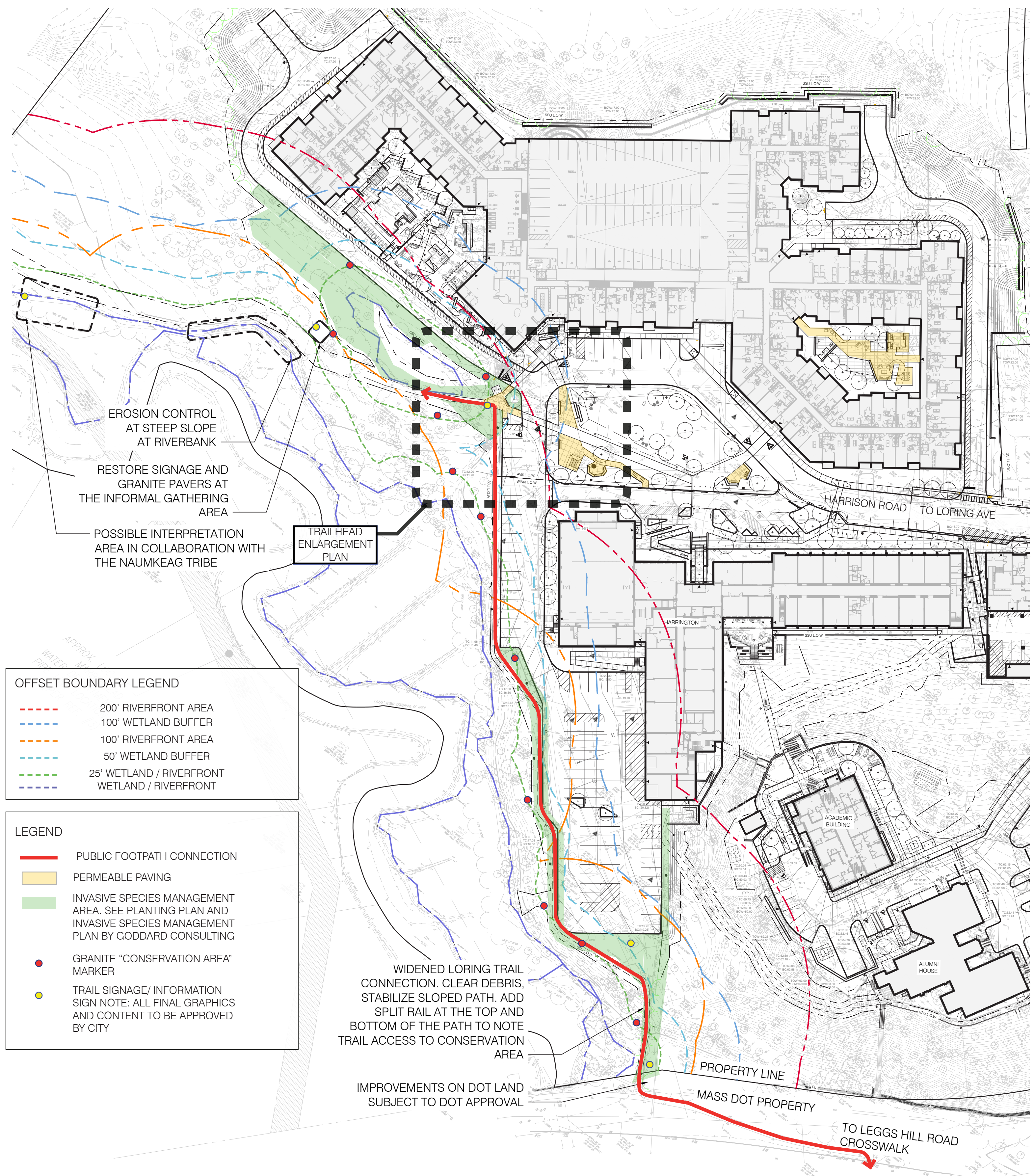

OFFSET BOUNDARY LEGEND

--- (Red dashed)	200' RIVERFRONT AREA
--- (Blue dashed)	100' WETLAND BUFFER
--- (Orange dashed)	100' RIVERFRONT AREA
--- (Green dashed)	50' WETLAND BUFFER
--- (Purple dashed)	25' WETLAND / RIVERFRONT WETLAND / RIVERFRONT

LEGEND

— (Red solid)	PUBLIC FOOTPATH CONNECTION
— (Yellow solid)	PERMEABLE PAVING
— (Green solid)	INVASIVE SPECIES MANAGEMENT AREA - SEE PLANTING PLAN AND INVASIVE SPECIES MANAGEMENT PLAN BY GODDARD CONSULTING
● (Red)	GRANITE "CONSERVATION AREA" MARKER
● (Yellow)	TRAIL SIGNAGE/ INFORMATION SIGN NOTE: ALL FINAL GRAPHICS AND CONTENT TO BE APPROVED BY CITY

1 OVERALL PLAN
 SCALE: 1" = 60'

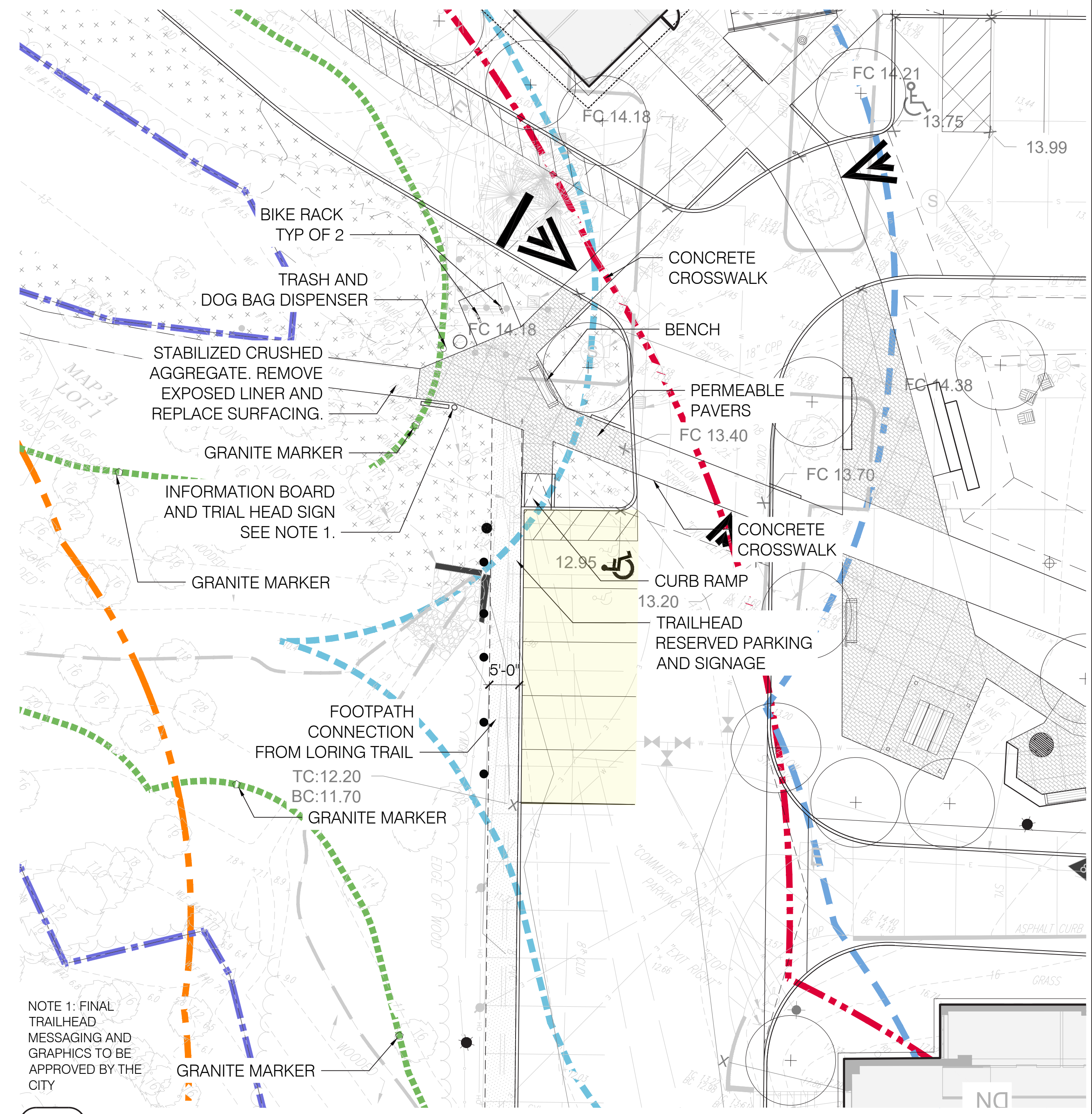
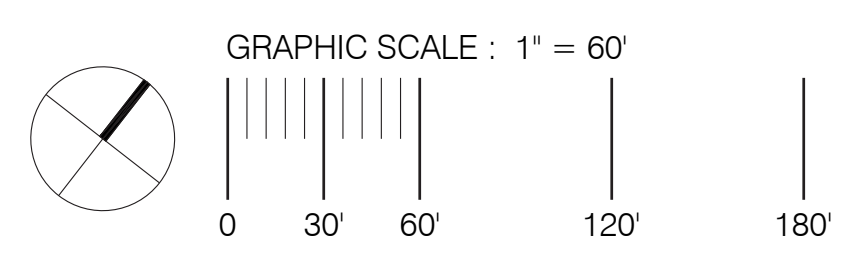

2 ENLARGEMENT PLAN
 SCALE: 1/8" = 1'-0"

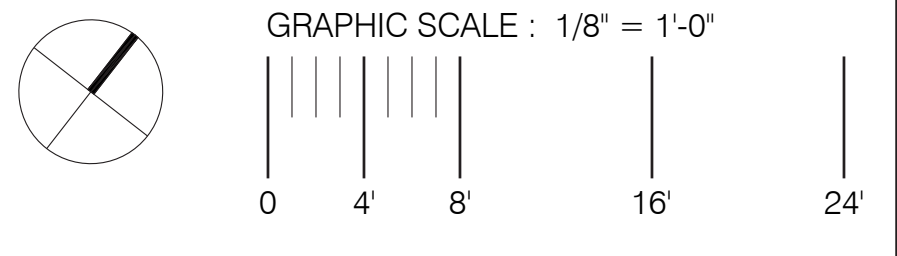

C:_Projects\kmdg_221225_Salem_State_South_Campus_Redevelopment\040101.1_Terracing_Enlight_Oversight_Plan.dwg